

SOFTINJECT® Autoinjector

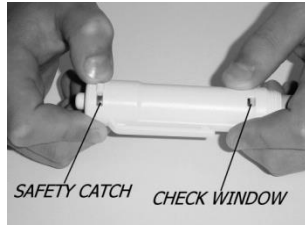

- Lock the *Safety Catch* by turning the clip on the top of the Softinject. Red color appears when *Safety Catch* is locked
- Unscrew the Softinject

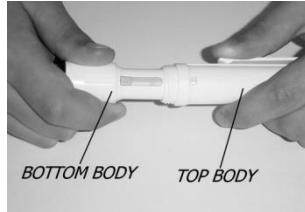

- Prime Softinject by pushing the internal plunger placed into the *Top Body* with the tip of the *Bottom Body*, exerting a light pressure until you feel a resistance and hear a click.



- Insert the pre-loaded syringe into the *Bottom Body* without removing the *Needle Protection*.
- Screw the two parts of Softinject together making sure they are perfectly aligned. Never force the threads and start the assembling again if the bodies do not screw together properly. The Softinject now is loaded and, since *Safety Catch* is on, it cannot be fired accidentally.



- The depth of needle penetration can be adjusted by turning the transparent *Depth Adjuster*. It is possible to set four different penetration depths :

S - Shallow (6 mm)
M - Medium (8 mm)
L - Deep (10 mm)
XL - Very Deep (12 mm)

The Softinject now is ready for use.

Injection

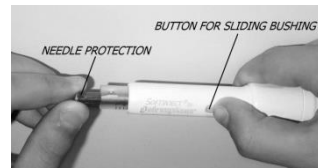

- Hold the device in a vertical position downwards. Push the *Button for Sliding Bushing* from the *Bottom Body* of injector in a downwards direction as far as it will go, thus exposing the *Needle Protection* which protects the needle.

- Remove the *Needle Protection*
- Release the *Button of Sliding Bushing* which springs back into its original position and draws the needle back into the injector.

- Unlock the *Safety Catch*. Green color appears when safety catch is unlocked.

- Clean the injection site with a disinfectant.

- Hold the injector perpendicular to the injection site as shown in the picture.

- Press the *Trigger Button* and wait until the red color appears through the *Check Window* (hold for 10 seconds)



After Injection

- When the injection is completed, raise the SOFTINJECT slowly.
- Make a slight pressure over the injection site with a swab of disinfectant.

BE CAREFUL: if bleeding continues to exert a slight pressure until to arrest the loss.

- Lock the *Safety Catch*
- Unscrew the SOFTINJECT bodies
- Remove the syringe
- Replace the *Needle Protection*
- Throw the syringe
- Replace the autoinjector into the box

The syringe and needle can be used only once and thrown in the appropriate containers.

Maintenance

The Softinject should be used according to the instructions.

Clean the exterior body of autoinjector using damp cloth and dry immediately.

If the internal bushing that hold the syringe placed into the lower body doesn't slide freely, wash it with warm water and dry immediately.

The manufacturer disclaims any responsibility for damages caused by improper use.

Safety Precautions

- ✚ Never repair the defective Softinject
- ✚ Never discharge the autoinjector empty! It might damage the discharge mechanism
- ✚ Do not point Softinject at yourself or anyone else.
- ✚ Before use to make sure that the autoinjector is in perfect condition and fully functional.

The SOFTINJECT® is an autoinjector specifically designed for subcutaneous and intracavernous injection with plastic disposable syringe:

- BD Micro-Fine™+ 1ml with fixed needle 29GX12,7 mm
- PIC Insuamed 1ml with fixed needle 30GX12,7 mm
- or similar syringes

Softinject Details

Details : A = Depth Adjuster B = Bottom Body
C = Button for Sliding Bushing D = Check Window
F = Top Body H = Safety Catch
L = Trigger Button M = Needle Protection

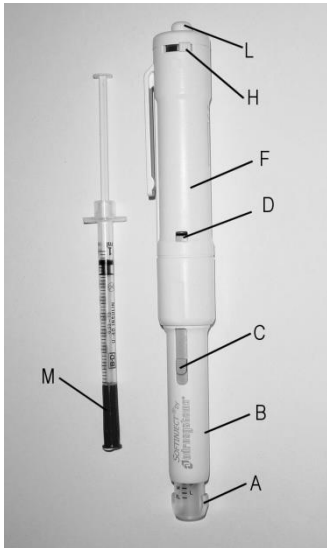

Instruction for Use

Preparation

BE CAREFUL: before use to make sure that the autoinjector is in perfect condition and fully functional.

Manufacturer and Distributor:

ANDROSYSTEMS SRL
Via Carlo Muscetta, 224
00139 Roma - Italy
☎ +39 320 63 85 191
@ clienti@androsystems.it
www.autoiniettori.it

CE 0373

IST SP 04/18

15/03/2018